

Articolo /item

Codice / Code

BENCH REST WITHOUT BACKREST

AP009P

Finitura /Finishing

GALVANIZED AND POWDER COATED



Bench Rest is completely made in galvanized and powder coated steel.

Seating is made of 22 tubulars $\varnothing 16 \times 1,5$ mm, closed at the extremities by PVC caps, welded to the 3 laser-cut steel sheet supports 5 mm thick and, in their turn, welded to a horizontal tube $\varnothing 60 \times 2$ mm closed at the extremities with PVC caps.

The two arc-shaped legs are made in tubular $\varnothing 48 \times 2$ mm and are screwed to the central tube: they can be supplied both with drilled base plates for the anchoring to the ground through bolts and with an extension to be in-ground mounted.

Screws are in stainless steel.

Very elegant and robust, it can be installed in every quality context, both indoor and outdoor.

TECHNICAL INFORMATION

Dimensions 1970 x 641 mm

Height 421 mm

Estimated weight 42 kg

Package

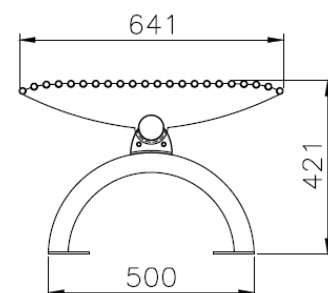
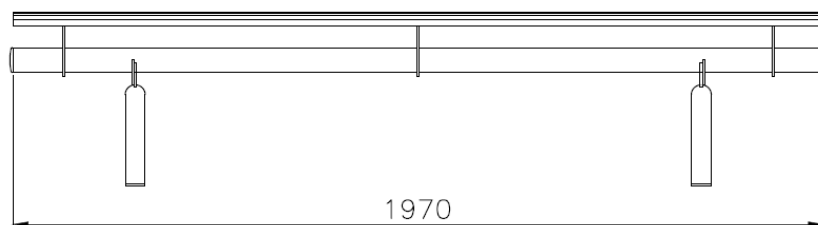

NOTE