

SCALE 1:50

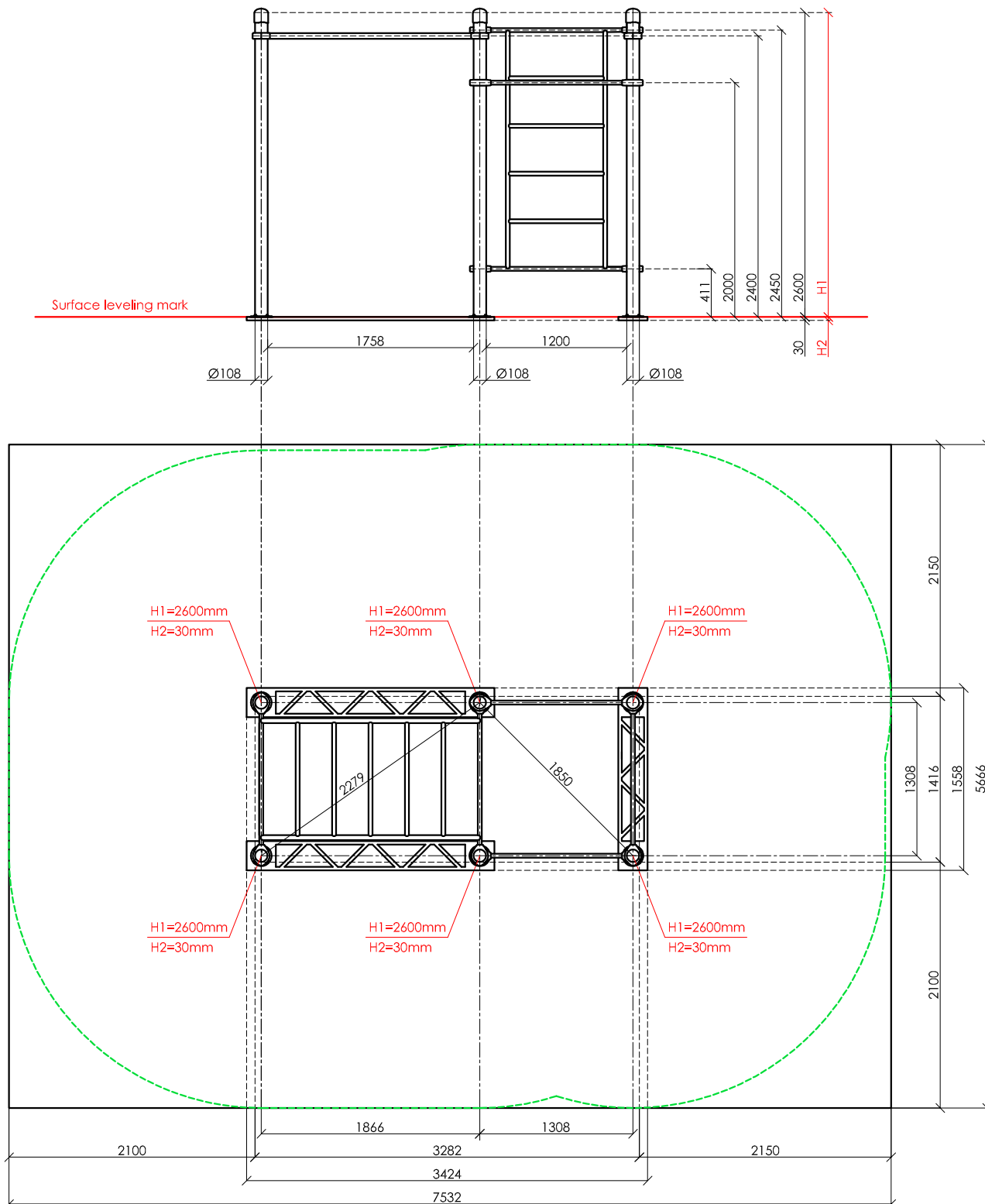
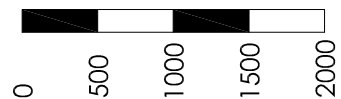

**KENGURU  
PRO**

**"KENGURU PRO" LTD**

Address: Lauteres street 4, Riga, Latvia, LV-1002  
 VAT Reg. No. 40103750152  
 Bank: A/S Luminor bank, SWIFT: RIKOLV2X,  
 Bank Account: LV65RIKO0002930161161  
 e-mail: info@kengurupro.eu  
 www.kengurupro.eu

D-4

Kenguru INDOOR



The complex consists of six vertical columns with different height, two crossbars 1200 mm in length, monkey bar and Swedish wall. Height of the Swedish wall – 2073 mm, width – 1200 mm. The distance between the crossbars of the Swedish wall – 407 mm. Monkey bar section length is 1900 mm. The distance between the crossbars of the monkey bar is 311 mm. Construction is secured together with siluminium clamps. Complex can be ordered on stability plates or simply on flanges that must be screwed to the ground.

Technical information

width:	1558 mm (1416 mm without stability plates)	
height:	2680 mm (2650 mm without stability plates)	
length:	3424 mm (3282mm without stability plates)	
largest part:	2650 mm	
weight:	312,3 kg (252,6 kg without stability plates)	
floor space required	7532 x 5666 mm	
pipe measurements:	diameter:	wall thickness:
	108 mm	3.2 mm
	42,4 mm	3.2 mm
	33,7 mm	3.2 mm
metal parts:	steel, galvanized, powder coated RAL 7016 (anthracite grey)	
metal clamps:	siluminium, powder coated, RAL 5018 (turquoise blue)	
bolts for metal clamps	stainless steel, Pin Hex Button Head Security bolts M10	
max. free fall height:	< 2450 mm	possible underground see DIN 79000:2012-05 Tab.2 or installation instructions
user height:	> 140 cm	
maximum user weight:	130 kg	
certificates:		