

SCALE 1:40

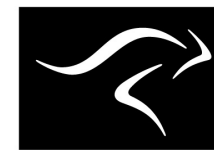
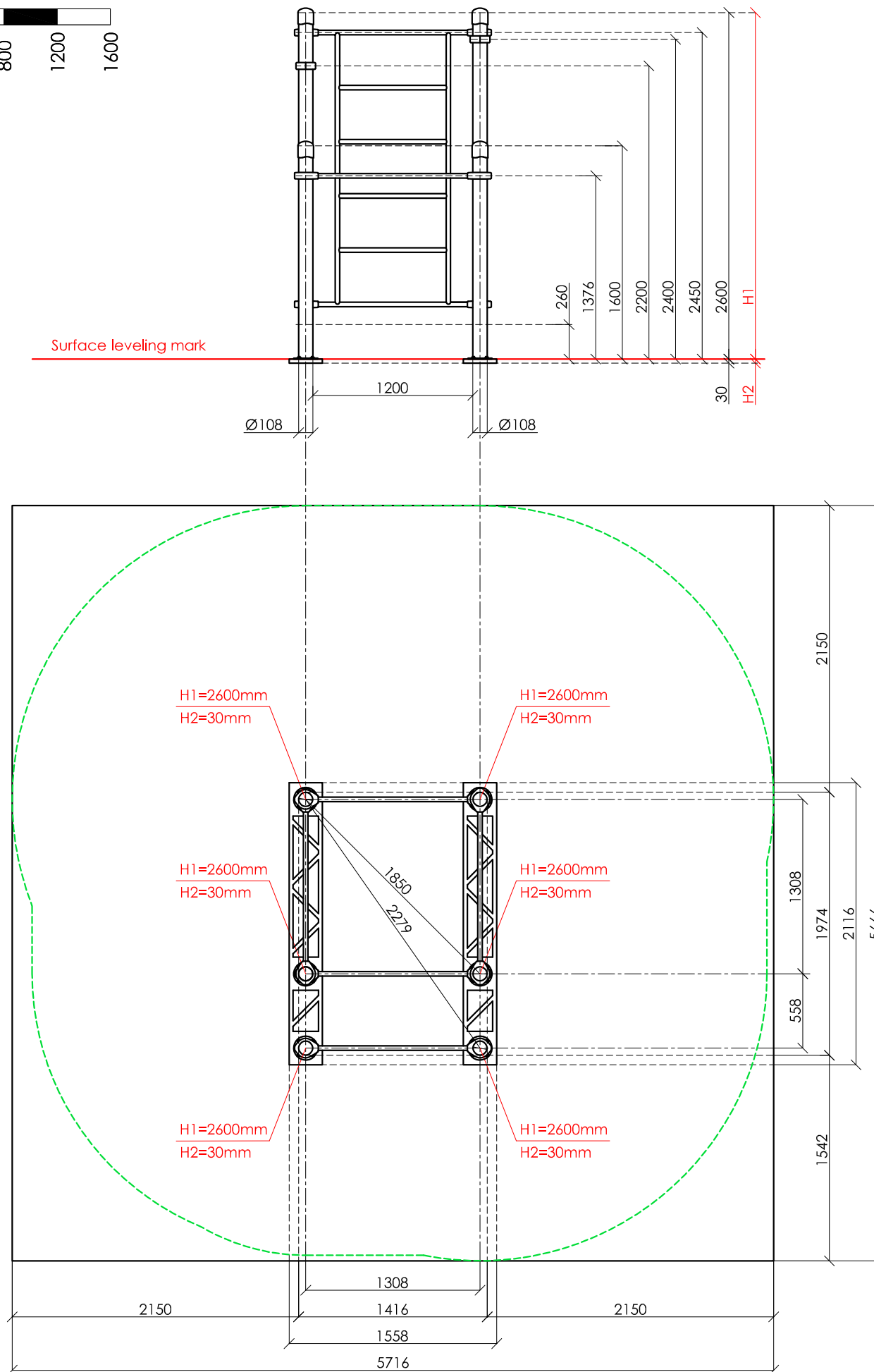
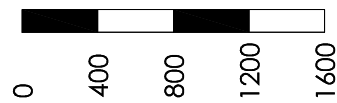

**KENGURU  
PRO**

"KENGURU PRO" LTD

Address: Lauteres street 4, Riga, Latvia, LV-1002  
 VAT Reg. No. 40103750152  
 Bank: A/S Luminor bank, SWIFT: RIKOLV2X ,  
 Bank Account: LV65RIKO0002930161161  
 e-mail: info@kengurupro.eu  
 www.kengurupro.eu

D-3

Kenguru INDOOR

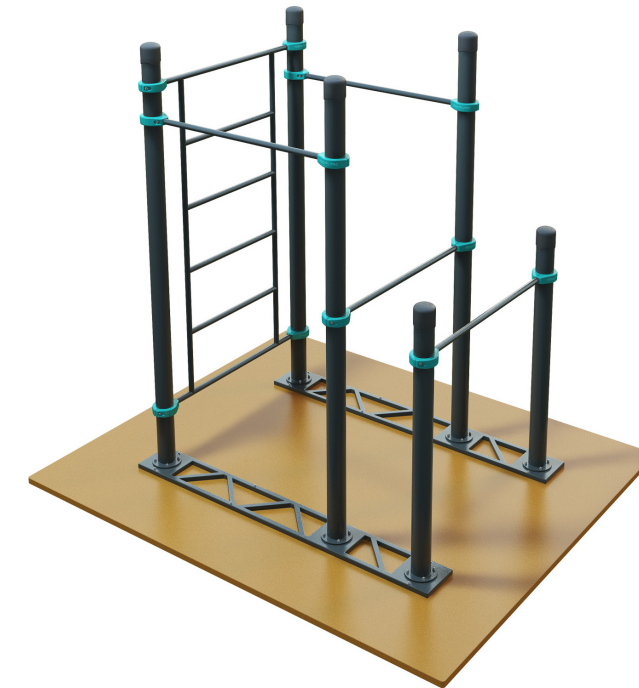

The complex consists of six vertical columns with different height, four crossbars 1200 mm in length and Swedish wall. Height of the Swedish wall - 2073 mm, width - 1200 mm. The distance between the crossbars of the Swedish wall - 407 mm. Construction is secured together with siluminium clamps. Complex can be ordered on stability plates or simply on flanges that must be screwed to the ground.

Technical information

width:	1558 mm (1416 mm without stability plates)	
height:	2680 mm (2650 mm without stability plates)	
length:	2116 mm (1974 mm without stability plates)	
largest part:	2650 mm	
weight:	245,6 kg (198,0 kg without stability plates)	
floor space required	5716 x 5666 mm	
pipe measurements:	diameter:	wall thickness:
	108 mm	3.2 mm
	33,7 mm	3.2 mm
metal parts:	steel, galvanized, powder coated RAL 7016 (anthracite grey)	
metal clamps:	siluminium, powder coated, RAL 5018 (turquoise blue)	
bolts for metal clamps	stainless steel, Pin Hex Button Head Security bolts M10	
max. free fall height:	< 2450 mm	possible underground see DIN 79000:2012-05 Tab.2 or installation instructions
user height:	> 140 cm	
maximum user weight:	130 kg	
certificates:		